

Model: RPCA-1 Insulated Curb Adapter (Smaller Top)

Standard Construction:

Minimum 18ga. Galvanized construction, 1" insulation glued and pinned. Covered area is sloped for water run-off. All welds micro-sealed and prime painted after fabrication.

Added Options (When Required):

RPI Job #: -

Project: _____

Architect: _____

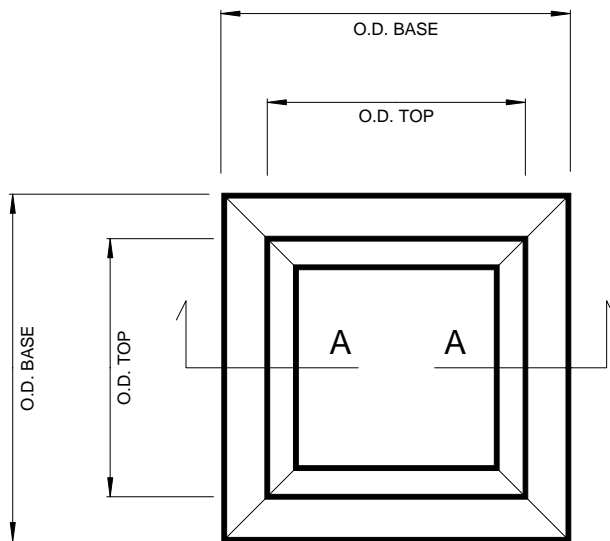

PLAN

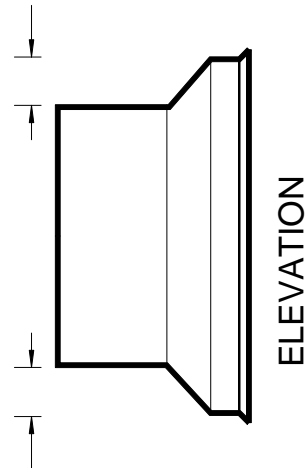

ELEVATION

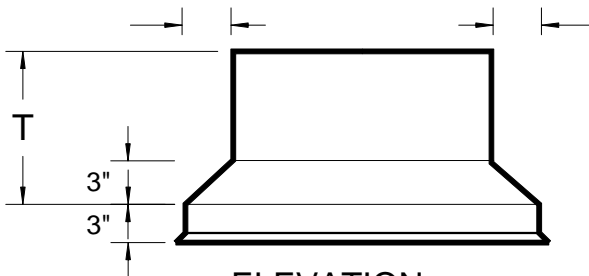

ELEVATION

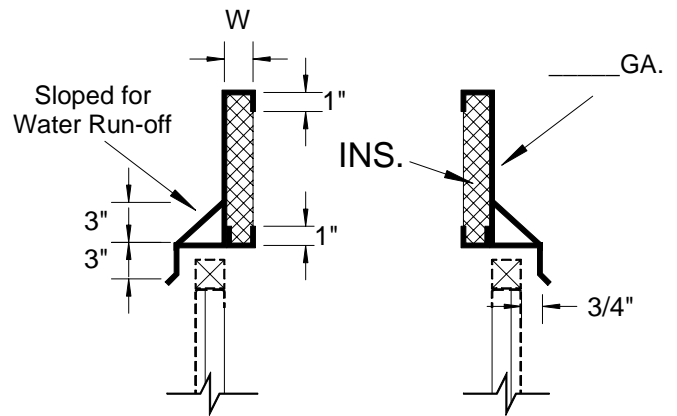

SECTION A-A

Qty.	O.D. BASE	O.D. TOP	T	W	Tag: